

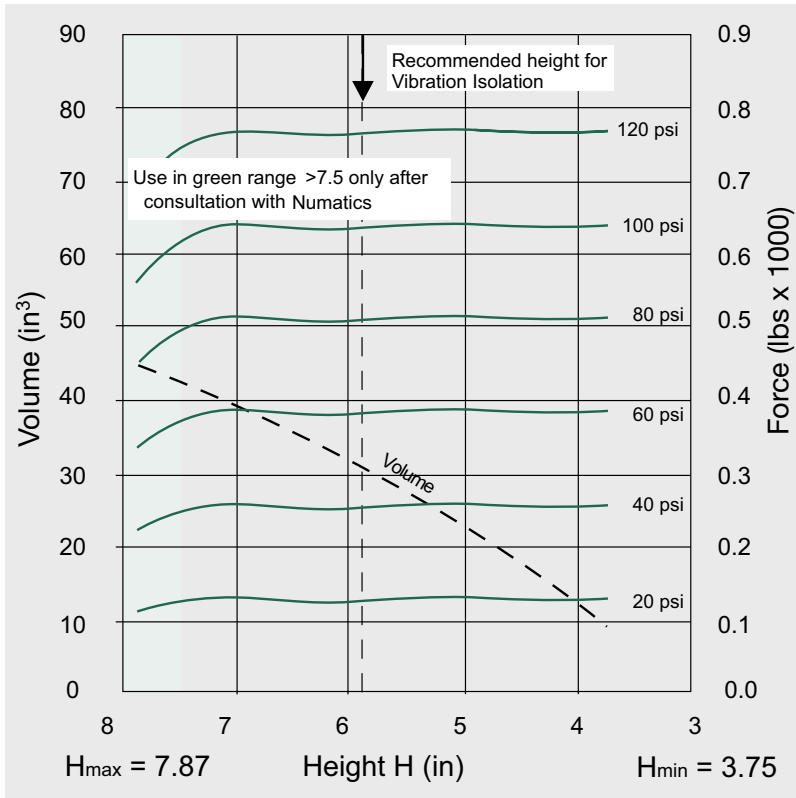

### Numatics Sleeve Type Air Bellows

ASNC8-4-1



Force-Height Diagram

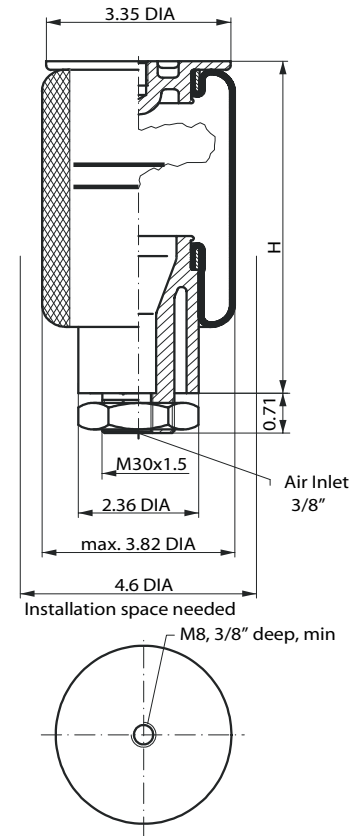

#### TECHNICAL DATA

Min. Pressure	13.05 PSI
Return Force to Min. Height	≤ 101 lbs
Overall Weight with Clamped Plates	1.15 lbs

#### Vibration Isolation – Dynamic Characteristic Values

Design Height H: Recommended 5.9 Inch, lateral guidance necessary						
Pressure p (psi)	40	60	80	100	120	Vol (in <sup>3</sup> )
Force (Load) (lbs)	260	380	510	640	770	
Spring Rate (lbs/in)	97	142	186	228	272	31
Natural Frequency (Hz)	2.0	1.9	1.9	1.9	1.9	

#### Pneumatic Application – Static Characteristic Values

Force F (lbs)								
Pressure p (psi)	20	40	60	80	100	120	Vol (in <sup>3</sup> )	
Height H (in)	7	130	260	380	510	640	770	39
	6	130	260	380	510	640	770	32
	5	130	260	380	510	640	770	25
	4	130	260	380	510	640	770	18

#### ORDER DATA

Type	Model Number
With 3/8" air inlet	ASNC8-4-1

Additional types on request

Installation Instruction  
M8 = 4 LBxFT  
M30x1.5 = 28 LBxFT  
G 3/8 = 7 LBxFT